

Site Map for 'Britain from the Air' at Oxford Castle

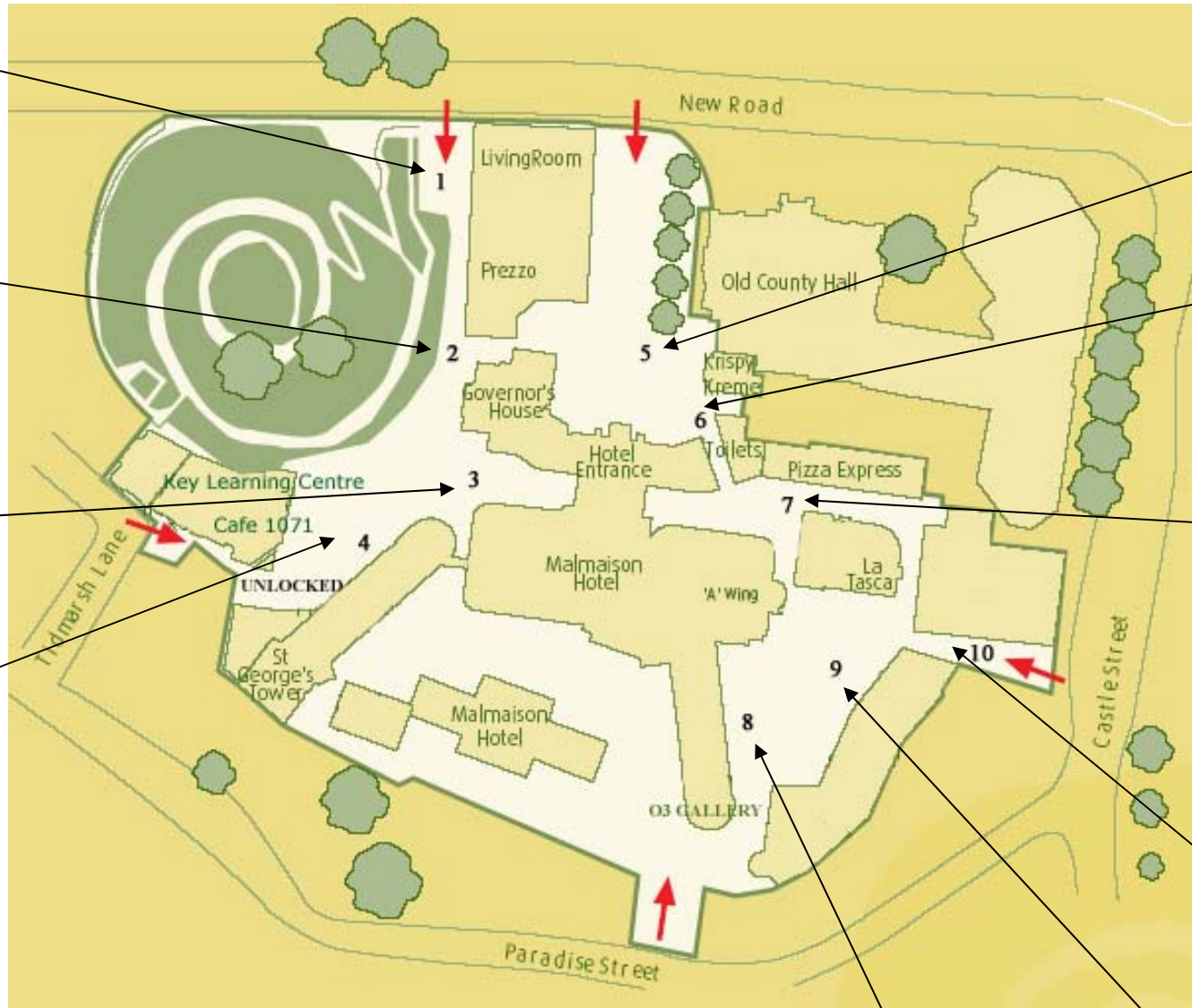

www.britainfromtheair.com
www.rgs.org/bfta

© Oxford Castle Unlocked

Citizenship

- Discuss with pupils how they feel about climate change and global warming. Include practical simple steps they can take.
- Ask students to identify photographs that show migration within the UK and think about the consequences for town development and planning
- Look for images of different local communities eg in cities, villages, coastal areas and discuss their different needs

Science

- Ask students to find photographs that illustrate these themes:
 - Energy – how we save, renew and waste it
 - Water – how it is supplied, used and conserved
 - Global warming and rising sea levels
 - Pollution, waste and recycling
 - Human impact on the environment
- Use the photographs and 'Useful websites' to stimulate discussion and activities on these themes

Geography

- Look for examples of different habitats or landscapes in the photographs
- Discuss the importance of tourism to Britain and the different tourist attractions shown in the photographs
- Look for examples of different jobs that people do. Research the types of industry in different parts of Britain.
- Ask pupils to choose a favourite photograph and find it on the map of Britain (area 9). Discuss with pupils which countries they have visited or where they have relatives.

English and Drama

- Use one of the images as a starting point for a story or poem. The worksheet 'Every Picture Tells a Story' could help students plan their story.
- Ask pupils to work in groups, each group finding a different photograph that they could use for a role play. There are suitable photographs in areas 1, 3, 4, 5, 8. Each group can plan their role play then take it in turns to perform for the class in front of their chosen picture.
- Develop understanding and writing of non-fiction text eg extracting information from the captions, writing a review of the exhibition for different audiences

BRITAIN FROM THE AIR

at Oxford Castle

Suggestions for using the exhibition across the Curriculum

Art and Design

- Give the pupils a viewfinder with a different shape in the centre eg rectangle, triangle, circle. Ask them to find those shapes in the photographs.
- Record the patterns and shapes in the photographs (see worksheet 'A Country of Patterns')
- Use the patterns, colours and shapes to inspire art or textile work

History

- Investigate how castles have changed – structure, defences and purpose
- Research different historical traditions shown in the photographs eg cheese rolling, swan census, Eights Week
- Chart the changes in one photograph's location eg through a timeline, individual's perspective, methods of transport or economic development

Oxfordshire Photographs

Area 1	The Origins of the Historic City	View of Oxford down the High
Area 1	Blenheim Palace	
Area 3	White Horse, Uffington	
Area 4	A City Bounded by Water	View of Oxford from the South
Area 5	The Evolution of the City	Dreaming Spires view
Area 5	The Start of Two Stories	Folly Bridge
Area 6	A Natural Flood Plain Defence	Port Meadow
Area 7	Oxford Castle: History in the Making	Castle mound
Area 7	Oxford's Sporting Achievements	Running Track and the Plain
Area 8	Cars and Crops	BMW Plant & Blackbird Leys
Area 9	Swinford Toll Bridge & the River Thames	

Coastal Processes

Area 1	The Needles
Area 4	Pagham Spit
Area 5	Saltburn Cliffs
Area 9	Lulworth Cove

Coastal Management

Area 3	Beach Reclamation
Area 5	Happisburgh
Area 8	Sandbanks

Urban Regeneration

Area 2	Angel of the North
Area 5	Olympic Park
Area 9	Birmingham Canals

Flood Risk and Flood Management

Area 1	River Dee in Flood
Area 3	Tewkesbury
Area 6	A Natural Flood Plain Defence (Port Meadow)

Tourism and Leisure

Area 1	Blenheim Palace
Area 3	Giants' Causeway
Area 3	London Eye
Area 3	Bluewater
Area 3	Fairground
Area 3	Glastonbury
Area 3	Wembley
Area 4	Buckingham Palace
Area 4	Hampton Court
Area 7	Oxford Castle

History and heritage

Area 1	Redsands Sea Fort
Area 1	Roman Amphitheatre
Area 3	Maiden Castle
Area 4	Caerphilly Castle
Area 4	Raby Castle
Area 4	Bamburgh Castle
Area 4	St Kilda
Area 6	Hadrian's Wall
Area 9	Roman Baths & Pump Room
	All the Oxfordshire photographs

Formation of landscapes

Area 1	Wye Valley
Area 1	Norfolk Broads
Area 1	Brecon Beacons
Area 2	South Harris
Area 3	Fields in Winter
Area 3	Dee Estuary
Area 3	Suilven
Area 3	Giant's Causeway
Area 4	Wast Water Screens
Area 4	South Downs
Area 6	Somerset Levels
Area 9	Fens
Area 9	Glen Tilt

Trade and Industry

Area 1	City and Docklands
Area 1	Cammell Laird
Area 1	Liverpool Docks
Area 1	China Clay
Area 1	Sultan Pit Pony
Area 3	Bluewater
Area 3	Fishing Nets
Area 3	Ely Cathedral
Area 4	Sheffield
Area 4	Container Port
Area 5	Cement Works
Area 8	Severn Crossing
Area 9	Wigan Mills

Environmental Change – cause and consequence

Area 1	Squabb Wood
Area 1	Rape Fields
Area 1	Polytunnels
Area 3	Harvest
Area 5	Cottam Power Station
Area 8	Severn Crossing
Area 9	Wind Farm

Useful websites

On the exhibition

www.britainfromtheair.com web site of the exhibition

www.rgs.org/bfta Royal Geographical Society web site, includes links to other Geography sites

Oxfordshire initiatives on environmental issues

<http://climatex.org/> on local community initiatives.

www.oxfordismyworld.org Oxford City guide to saving the planet

www.oxfordshire.gov.uk/futurefirst Helping Oxfordshire reduce its carbon footprint

On global citizenship and sustainable development

<http://www.teachingexpertise.com/articles/global-citizenship-in-school-1881> about global citizenship

<http://www.oxfam.org.uk/education/gc/> about global citizenship

<http://www.teachernet.gov.uk/sustainableschools/about/about.cfm> from EftA website, about sustainable development

www.globaldimension.org.uk teaching resources and background materials for giving a global dimension across the curriculum

<http://www.globalteacher.org.uk/resources.htm> about global citizenship

On climate change and individual action

http://www.earthcarecanada.com/EarthCARE_Program/EarthCARE_lessons.asp#activities

activities on energy efficiency, water consumption etc aimed at children

<http://www.yearofplanetearth.org/> about Planet Earth year

www.ltscotland.org.uk/climatechange/resources resources and games about climate change to encourage student involvement

www.climateprediction.net/schools/resources.php Predicting climate change. Aimed at KS3 and above

www.climatechallenge.gov.uk Government's website on climate change

www.defra.gov.uk/sustainable/government. Sustainable development indicators and adapting to climate change

www.recyclenow.com recycling waste

www.climatechangewales.org.uk

www.red-redemption.com computer games about climate change

www.sciencemuseum.org.uk/energy future energy sources

<http://www.bp.com/genericResource.do?categoryId=8043&contentId=7037470&Page=new> climate change resource pack

http://www.cat.org.uk/education/ed_content.tmpl?subdir=education&sku=ED_50 Centre for Alternative Technology resources

Carbon Footprint Calculators

www.google.co.uk/carbonfootprint

www.ecologicalfootprint.com

www.bp.com/bpes/cft

<http://www.imeasure.org.uk/> measuring energy use in the home